

Single-point Lubricator Series



Oil and grease



Electrochemical



Capacities



Single-point



S100 Electric Single-point Lubricator

Features

Cut costs	Replaceable cartridge and battery pack
Remote mounting	3MPa, within 10 meters
Lubrication point	Up to 8 lubrication points
Easy to use	Operation via the display buttons
Discharge	Arbitrarily set displacement
Automatic lock	With automatic lock function
Flexible mounting	Mounted on equipment with narrow space

Specifications

Capacity	Cartridge 60/125/250/500mL
Drive	4.5VDC standard alkaline battery, lithium battery
Pressure	3-6MPa
Operating temp	Alkaline -15~+60°C, Lithium -40~+60°C
Fill cycle	60mL: 1, 2, 3...12 months 125/250mL: 1, 2, 3, 6, 12 months, 15 days (H) 500mL: 1, 2, 4, 6, 12, 18, 24 months, 15 days (H)
Remote mount	Up to 10 meters, (Φ6 tube)
Lubrication point	Up to 6m, when Φ6 tube, 8 lubrication points
Displacement	0.34mL/cycle(20°C)
Protection level	CE/IP54

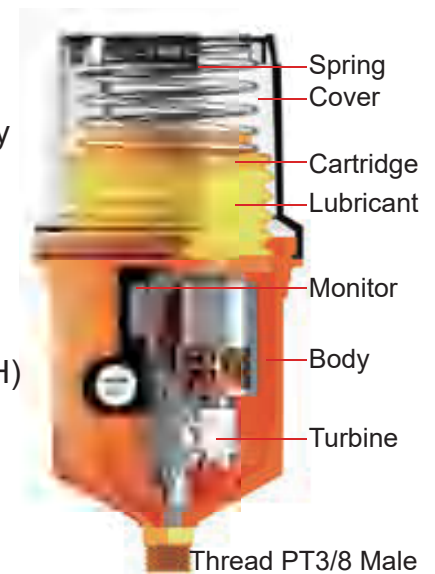

Applications



Clean rooms for automobile production equipment, ironmaking plant and nuclear power equipment.
 Linear guide rail and other equipment that need precise fatliquoring and multi-point fatliquoring.
 Engines and pumps for water and sewage treatment equipment.
 Cooling tower and other equipment requiring remote Fatliquoring.
 Remote equipment that cannot be manually greased due to low temperature, high temperature.

S200 Electric Single-point Lubricator

Features

- ◆ Lubrication time 0.5, 1, 3, 6, 9, 12 months can be set
Simple operation, precise settings
Settings can be changed at any time
Can be turned off during equipment downtime
- ◆ Battery-driven motors
Precise discharge, not affected by temperature and back pressure
Battery-driven motors can be reused to reduce costs
There will be a signal when there is an error in the system equipment, which reduces the cost
- ◆ Pressure up to 12bar, remote mounting up to 5 meters
Hazardous area and remote mounting improve the safety of the workplace and save time
High availability, replacement during operation
Lubrication point can be cleared to clear blockage



Specifications

Driver	Battery pack
lubrication cycle	0.5, 1, 3, 6, 9, 12 months
Displacement	125/250mL
Temperature	-10° to 60°C
Pressure	Maximum 12bar
Protection level	IP65
Lubricant	Thin oil or grease NLGI 2
Size	82x178mm(125mL)
Size	82x225mm(250mL)

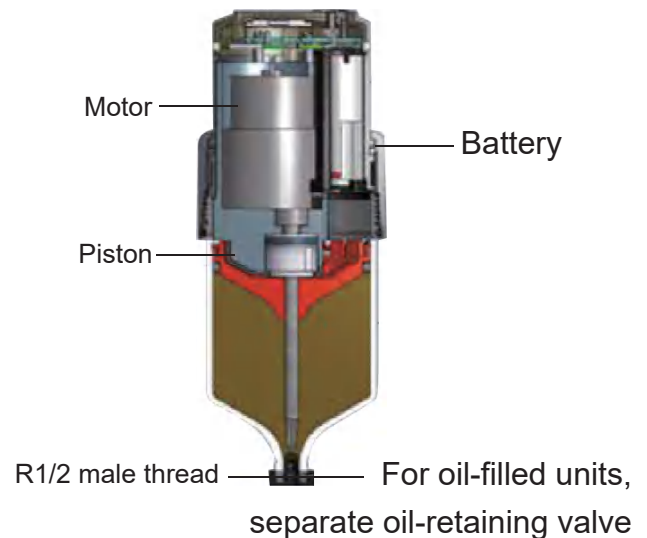

Applications

Applications in restrictive and hazardous locations and requiring high volumes of lubricant.

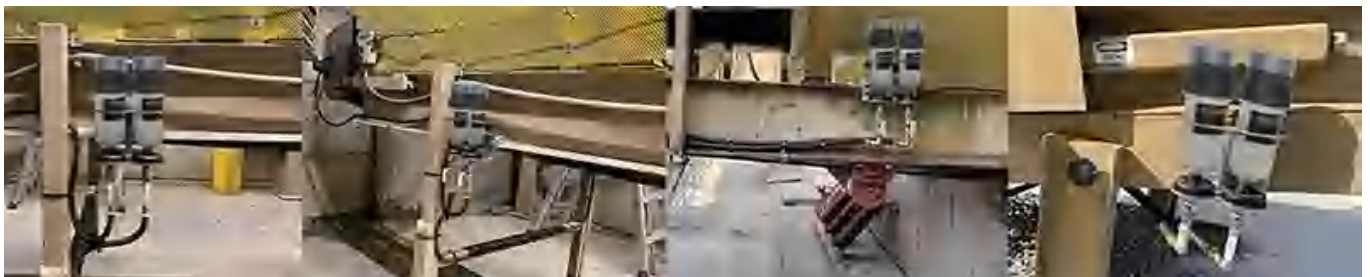

S300 Electrochemical Single-point Lubricator

Features

◆ Systems with rotary switches, the discharge cycle can be set to: 1, 3, 6, 9, 12 months

System can be mounted and used immediately

Rotate the switch to set and activate

The discharge cycle is one to twelve months

◆ Operating temperature: -20°C to 600°C

Can be used in various temperature ranges

Can be used outdoors all year round

◆ Protection class IP 68

Safe and reliable lubrication in explosive areas

Can be used in moist and dusty environments

Increased workplace safety



Specifications

Housing	Transparent plastic
Drive	Electrochemical reaction
Discharge period	1~12 months
Lubricant volume	60 and 125 cc
Operating temp.	20°C to 60°C
Pressure buildup	Max . 5 bar
Protection class	IP 68
Lubricants	grease up to NLGI 2

Applications



Electric motors, open gears, pumps, roller bearings, sliding bearings, etc.

S400 Electrochemical Single-point Lubricator

Features

- ◆ Simple activation: 1, 3, 6, 12 months.
Tamper-proof, easy to use.
Economical and permanent lubrication.
Quick replacement without tools.
- ◆ Metal housing, robust housing for use in harsh environments.
- ◆ Explosion proof standard.
Safe reliable lubrication in explosive areas.
Better workplace safety.
Suitable for underground use.





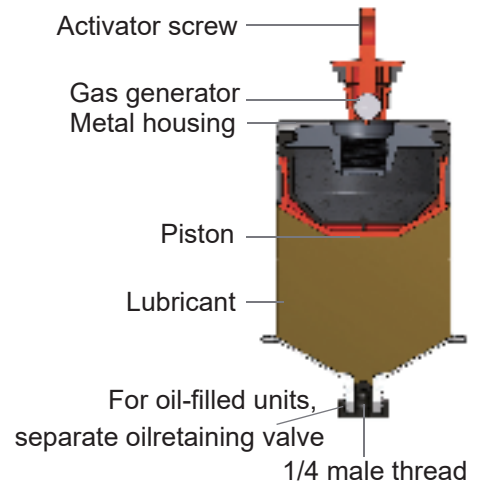

Specifications

Housing	Meta
Drive	Electrochemical reaction
Discharge	1,3,6 or 12 months
Capacity	120mL
Operating temp	0°C to 40°C
Pressure	Max 4 bar
Lubricants	Oil and grease up to NLGI 2
Dimensions	70x99mm



Time between activation and first discharge: 1 day

Temp \ Month	 Yellow	 Green	 Red	 Gray
	Yellow	Green	Red	Gray
0°C	4	8	15	> 18
10°C	2	5	8	18
20°C	1	3	6	12
30°C	0.8	2	3	6
40°C	0.6	1	2	3

Applications

Chains, gear racks, open gears, roller & sliding bearings, sliding guides, spindles, etc.

S500 Spring Single-point Lubricator

Features

1. Easy to install and operate.
2. The discharge grease flow rate can be adjusted.
3. The correct working temperature is about $-20\sim 125^{\circ}\text{C}$.

Specifications

Housing	Transparent plastic
Drive	Spring pressure
Discharge	Adjustable
Capacity	80mL or 150mL
Operating temp	$-20\sim 125^{\circ}\text{C}$
Lubricant	oil and grease up to NLGI3
Thread	M10x1
Dimensions	110mm x $\phi 51$ (80mL) 135mm x $\phi 61$ (150mL)

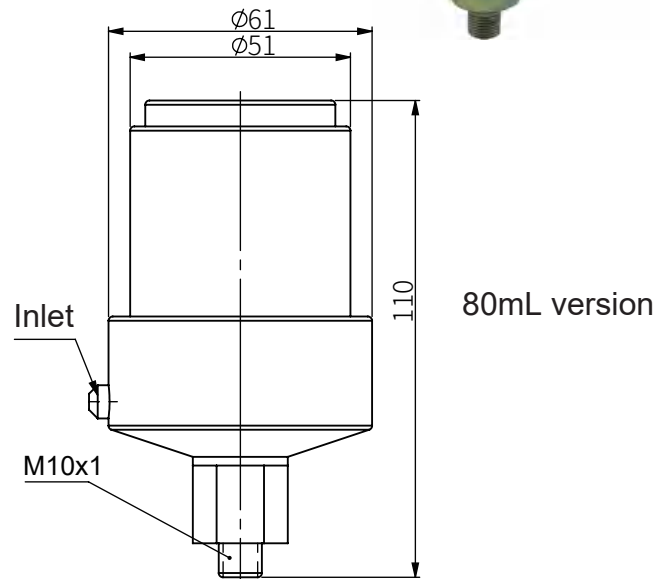

Applications

Chains, gear racks, open gears, roller & sliding bearings, sliding guides, spindles, etc.

