

MESOLUBE

MESOLUBE Centralized lubrication system Owner Manual



MESOLUBE

Dongguan Mingsheng Lubrication Technology Co. , Ltd.

Address: Building 3, Zhongda Industrial Park, Zhangmuou Town, Dongguan City, Guangdong Province China

telephone number:+860769-81111420

Telephone:+8613071306960

E-mail:he@mesolube.com

Http:www.mesolube.com

External Dimension Drawing

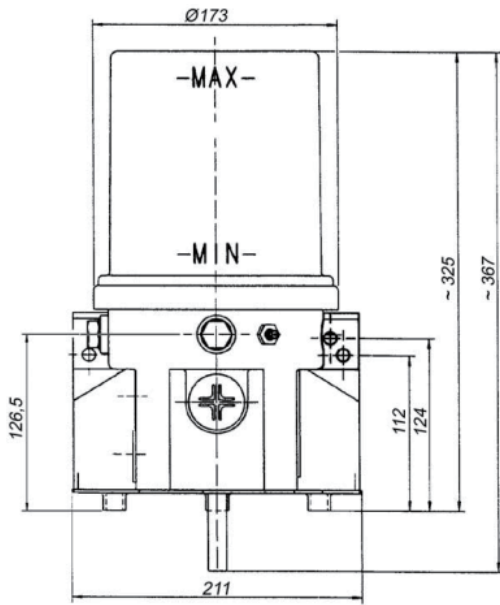

2L

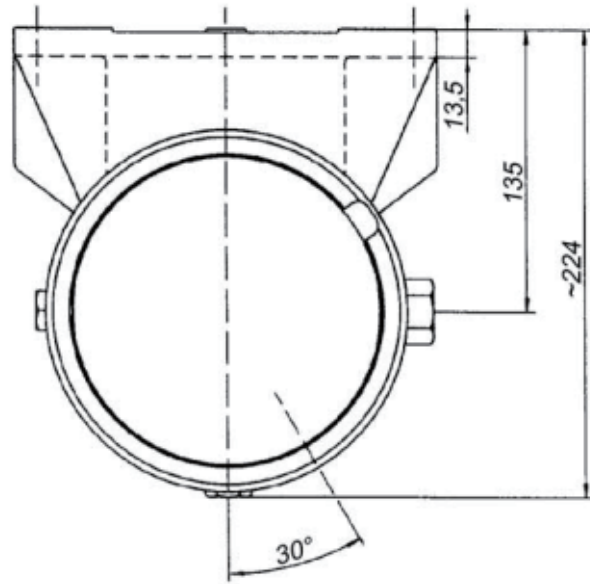

- A1 = 162 mm [6.38 in.]
- B1 = 180 mm [7.09 in.]
- A2 = 124 mm [4.88 in.]
- B2 = 112 mm [4.41 in.]

- C1 = 83 mm [3.27 in.]
- C2 = 95 mm [3.74 in.]

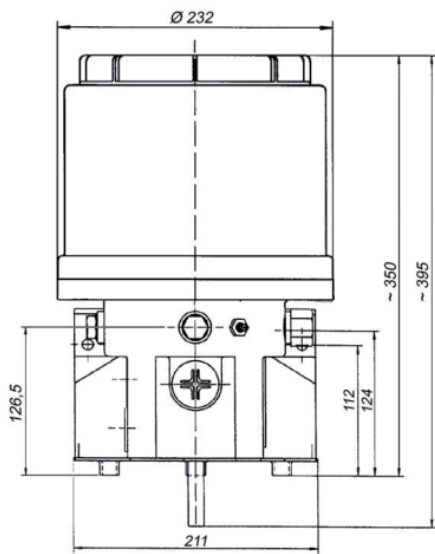

4L

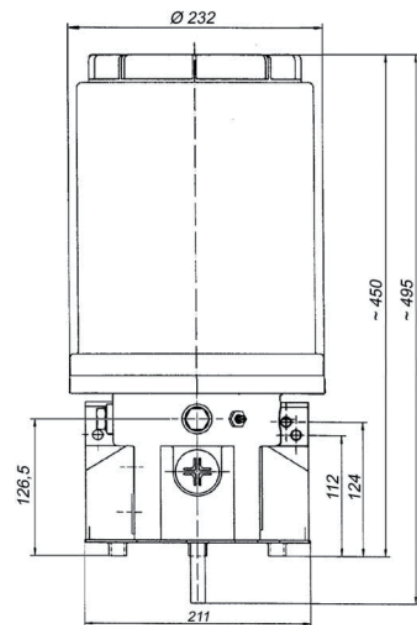
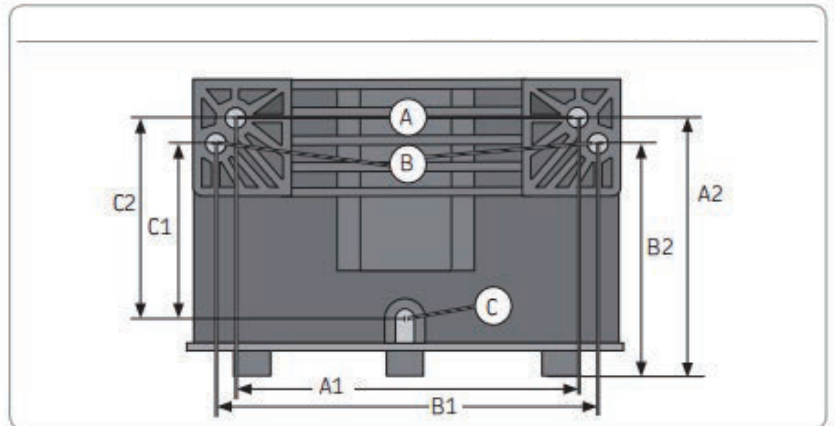

8L

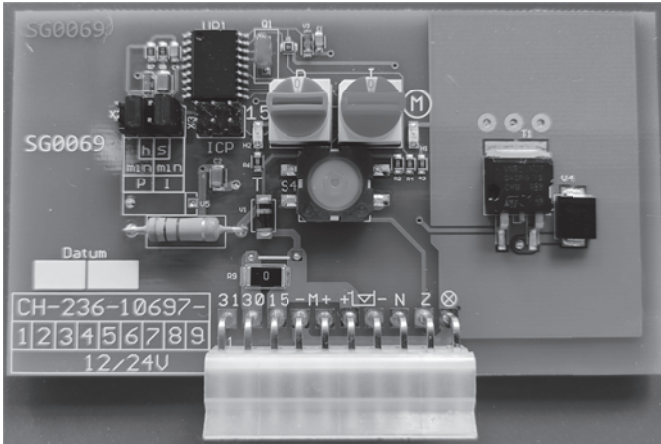

Fig. 1 - Printed circuit board

- The printed circuit board automatically controls the sequence of the pause and operating times of the model P300 central lubrication pump as a function of the vehicle or machine working hours t_B (Fig. 1).
- The sequence of the pause and operating times is activated when the machine contact or driving switch is switched on.

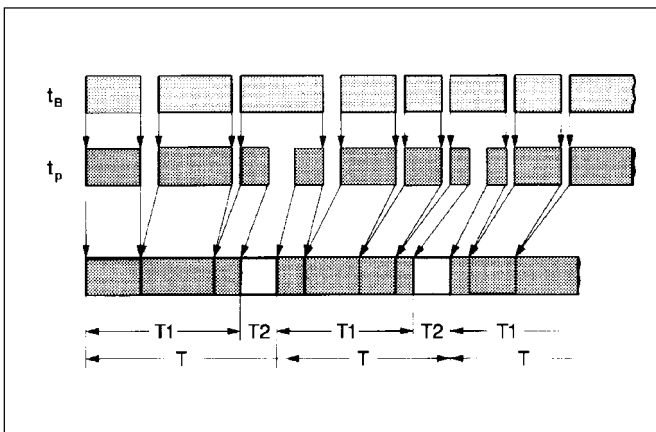

Fig.2 - Time sequence diagram

- A lubrication cycle consists of one pause time and one operating time. Once the pause time has elapsed, the operating time starts to run. This lubrication cycle is repeated permanently after the machine or vehicle has been put into operation. Refer to Fig. 2.
- During the operating time the pump element dispenses the lubricant to the lubrication points via progressive metering devices.

t_B - Working hours
 t_P - Various pause times

T - Lubrication cycle
 T1 - Stored pause times
 T2 - Operating times

Time Setting

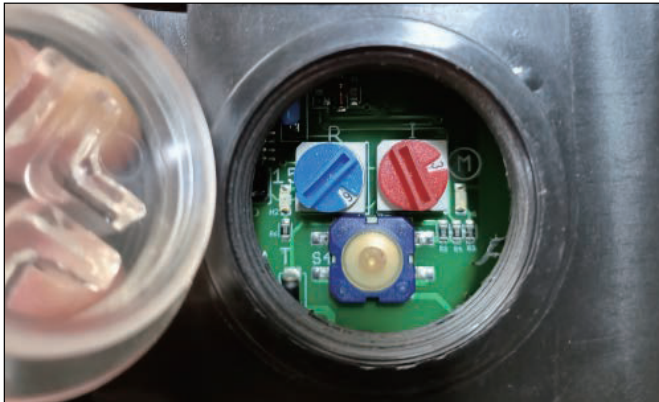

Fig. 3 - The cover to access the printed circuit board has been removed

* To set the pause or operating time, remove the cover on the pump housing.

Note: To reset a jumper (Fig. 3), remove the printed circuit board.

Important: ~~After having set the pause time~~ or operating time, screw the cover on the pump housing again

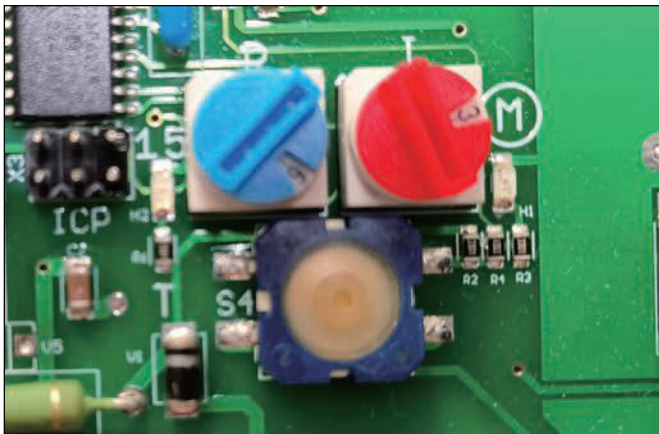

Fig. 4 - Rotary switch - Pause time

To set the pause time

The pause time can be set to 15 different settings by means of the **blue rotary switch**.

Time ranges: Minutes or hours

Switch position	1	2	3	4	5	6	7	8	9	A	B	C	D	E	F
Minutes	3,75	7,5	11,25	15	18,75	22,5	26,25	30	33,75	37,5	41,25	45	48,75	52,5	56,25
Hours	1	2	3	4	5	6	7	8	9	10	11	12	13	14	15

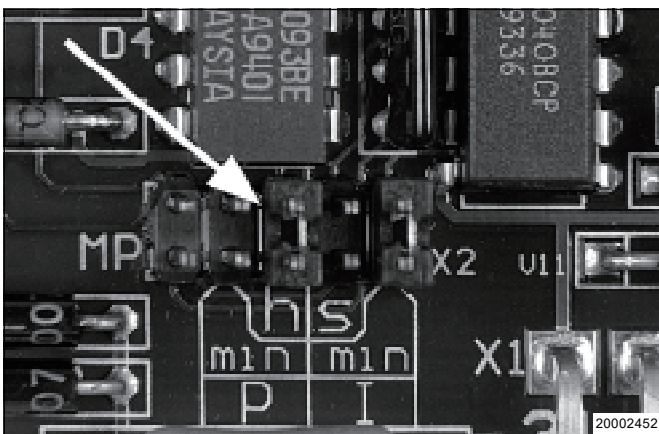

Fig. 5 - Preselection of the time range

Note: The 0 setting has no function.

Factory setting

Rotary switch on : 6 hours
 or 22.5 minutes

- The time ranges can be modified by replugging the jumper (Fig. 5) on the printed circuit board.
- Factory setting of the jumper The combination number can be learnt from the pump type designation code mentioned on the nameplate of each pump.

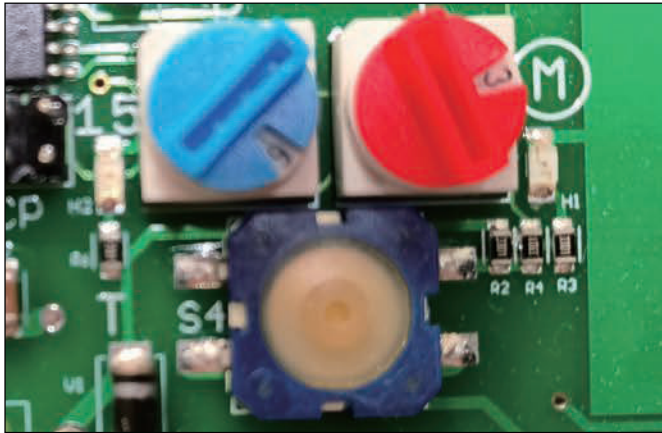

Fig. 6 - Rotary switch - Operating time

To set the operating time

- The operating time can be set to 15 different settings by means of the red rotary switch.

Time ranges: Seconds or minutes

Switch position	1	2	3	4	5	6	7	8	9	A	B	C	D	E	F
Seconds	7,5	15	22,5	30	37,5	45	52,5	60	67,5	75	82,5	90	97,5	105	112,5
Minutes	2	4	6	8	10	12	14	16	18	20	22	24	26	28	30

Note: The 0 setting has no function.

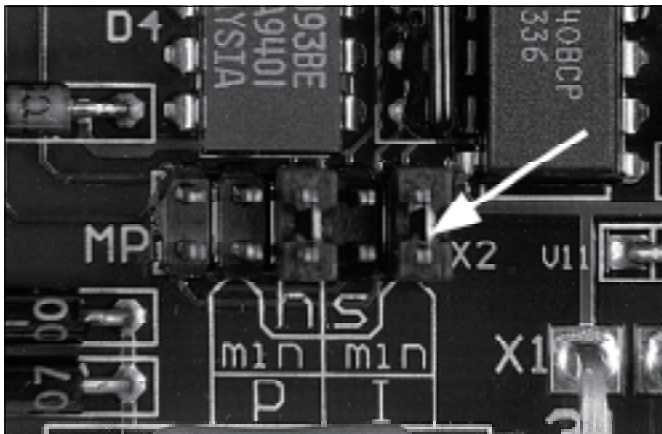

Fig. 7 - Preselection of the time range

Factory setting

Rotary switch on : 6 minutes
 or 22.5 seconds

- The time ranges can be modified by replugging the jumper (Fig. 7) on the printed circuit board.